



Changshu Catec Electronic Intl Ltd

#188 Suzhou Road, Yushan Hi-Tech Park,
Changshu-city 215500, Jiangsu, China
Tel: +86-512-52899768
Fax: +86-512-52780868
Service line: 400-6099-878
URL: www.labprovide.com
Email: catec@labprovide.com
Skype: [cscatec2012](https://www.skype.com/people/cscatec2012), [natalie213@hotmail.com](https://www.skype.com/people/natalie213), [terryoking](https://www.skype.com/people/terryoking)



CATEC

SAFETY EQUIPMENT

RELIABLE SAFETY STORAGE SOLUTION



Keeping your items secure from

humidity
damage

fire and
explosion

harmful
pollution

theft
and dust

oxidation

chemical
erosion



COMPANY PROFILE

We are manufacturer for safety equipment like safety cabinets, fume hoods, dry cabinets, n2 gas cabinets, drying ovens, auto lockers and other electronic appliances that can keep your items secure from fire and explosion, harmful pollution, humidity damage, theft or dust etc. With modern manufacture machines, advanced technology and strict quality control in production and constant technical innovating, our products are welcomed all over the world for industries of electronics, military projects, chemical engineering, research institute, lighting, optics, pharmacy, and so on.

CATEC SAFETY EQUIP, HOLDING YOUR SAFETY STORAGE CONCERNS

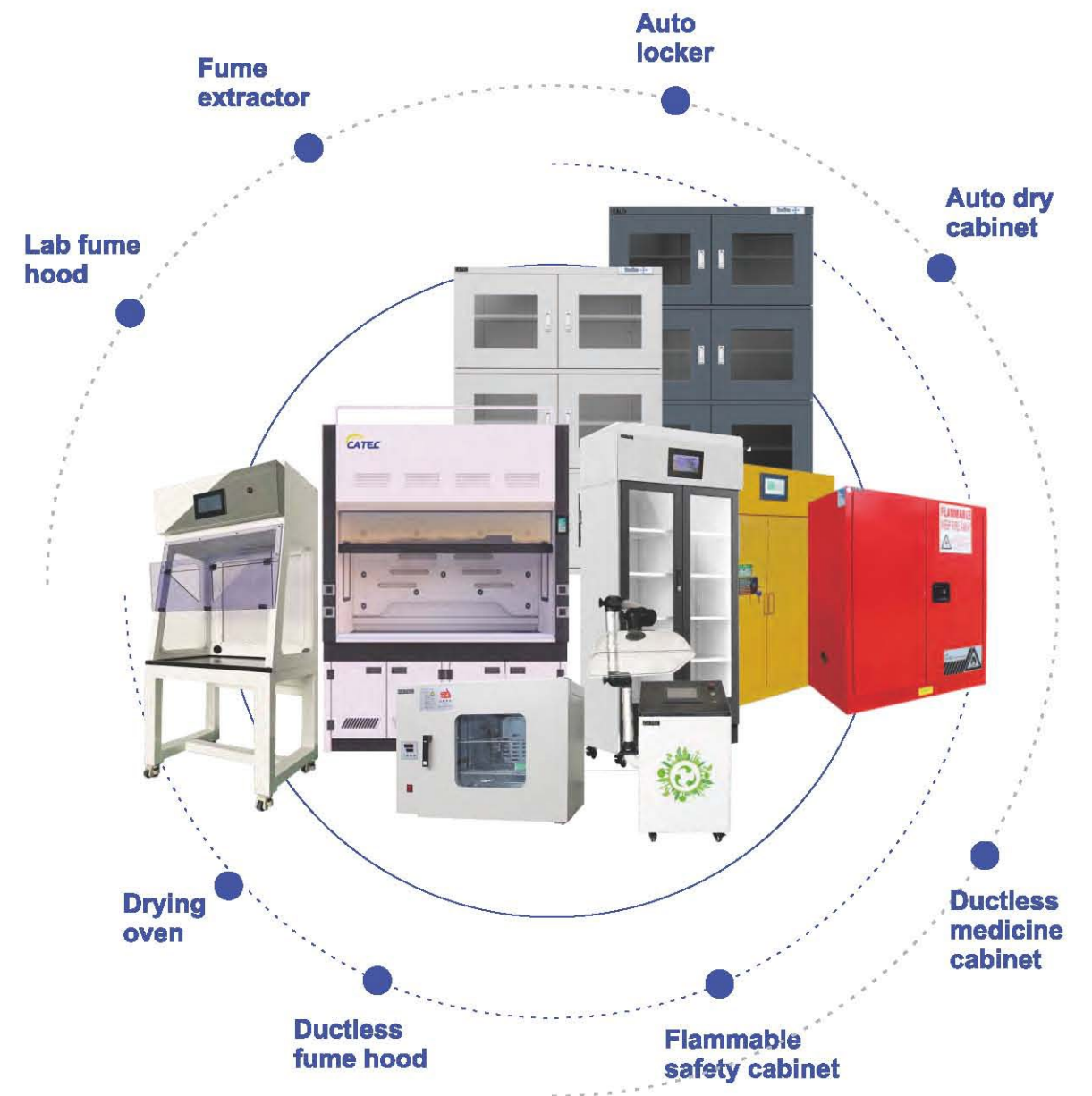

CATEC

SAFETY EQUIPMENT
RELIABLE SAFETY STORAGE SOLUTION

DUCTLESS SMART FILTRATION FUME HOOD



7 inch touch screen to monitor the ambient humidity/temp, VOC concentration, and alarming system

Strong activated carbon plus HEPA filtration conformed to ASTM standard

Imported PSC draught fan

Material: strong anti-erosion 8mm PP plate structure

25W LED light

Epoxy resin worktop

Front/side acrylic window≥6mm

Functions



Clean the air in laboratory



Overall filtering system



Air intake to create new circulation



clean the working space air

Technical details

Spec	CFS-DS800	CFS-DS1000	CFS-DM1275	CFS-DM1600	CFS-DL1600
Outer Size (W*D*H/mm)	800*620*1290	1000*620*1315	1275*620*1340	1600*620*1340	1600*790*1495
Inner Size (W*D*H/mm)	764*540*860	971*512*885	1172*522*866	1172*522*866	1497*692*1014
Filtering Rate	230m³/h 0.4-0.6m/s	230m³/h 0.4-0.6m/s	230m³/h 0.4-0.6m/s	460m³/h 0.4-0.6m/s	690m³/h 0.4-0.6m/s
Power	220V-240V 50/60Hz	220V-240V 50/60Hz	220V-240V 50/60Hz	220V-240V 50/60Hz	220V-240V 50/60Hz
Avg. Power	42W 3A	42W 3A	42W 3A	42W 3A	42W 3A
Volume	40dBA	40dBA	40dBA	40dBA	40dBA
Other Details	filter*1 set fan*1 LED light*1 7 inch LCD display epoxy resin worktop power cord alarming system				
Parts Options	fixed/movable base ceramics/SS/tempered glass worktop filter options: organic gas filter, inorganic gas filter, integrated filter				

LAMINAR FLOW CLEAN BENCH



Features

1. Applicable for experimental protection of biotechnology, pharmaceutical, life sciences and precision electronics.
2. Excellent airflow mechanical design to create a partial purification of working environment to ensure that experiments to be carried out successfully.
3. Designed as per standards of EN12469 and AS1386.5, clean grade per ISO14644.1CL ASS5 (U.S. Federal 209E, 100 level).
4. CE and RoHS certified, factory ISO9001 certified.
5. Advanced filtration system with AAF high efficiency filter with clapboard HEPA to catch pollution particles, of which the retention efficiency is ≥99.995%@MPPS, class H14 per EN1822, pressure drop 110Pa±15% @0.45m/s, size 570*1170*59mm.
6. Made of quality 8mm PP, polypropylene, with excellent anti-corrosion, better than the hood made of metal.
7. User-friendly design, with sterilization, lighting, interlock mechanism to protect the operator from UV light burning and ensure safe operation.
8. Wind speed multi-level and the air volume are adjustable as per demand.
9. Centrifugal wind wheel low-power motor, based on airflow mechanics principle, arc-shaped large-diameter inlet design to reduce turbulence for low noise in operation.
10. Reasonable duct design, optimized net press box, with micro-mesh design layer outflow wind deflector, convex, no dead ends, for uniformity and stability of the airflow.

Technical details

Spec	Outer Size (W*D*H/mm)	Inner Size (W*D*H/mm)	Filtering Efficiency	Pressure Drop	Work Top Material	Power
CFS-CBW1500	1500*750*2000	1200*730*1600	≥99.995% @MPPS	110Pa±15% @0.45m/s	SUS304 stainless steel	220V-240V 50/60Hz

DUCTLESS SMART FILTRATION MEDICINE CABINET



Air circulation diagram

Technical details

Spec	Outer Size (W*D*H/mm)	Inner Size (W*D*H/mm)	Filtering Rate	Power	Volume	Other Details	Parts Option
CFS-G800P	800*510*2170	710*450*1750	220m³/h	220V/50Hz 76W 3A	160bottles (500ml)	Filter*1 set fan*1 PP tray*5 LED light*1 7 inch LCD display alarming system	spare PP tray spare filter

DUCTLESS SMART FILTRATION MEDICINE CABINETS

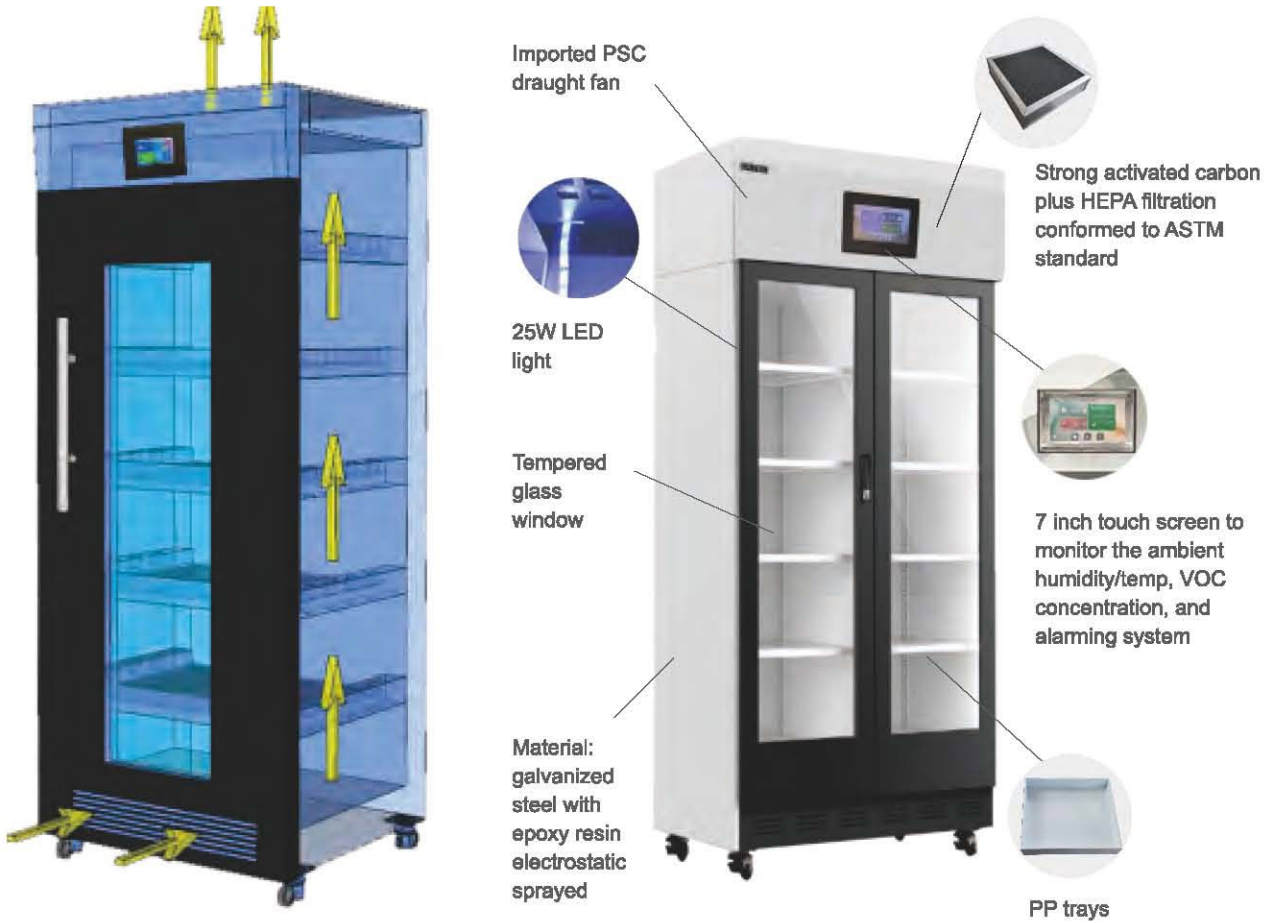

Air circulation diagram

Technical details

Spec	Outer Size (W*D*H/mm)	Inner Size (W*D*H/mm)	Filtering Rate	Power	Volume	Shelf	Other Details	Parts Option
CFS-G800	800*510*2150	760*432*1720	220m³/h	220V/50Hz 76W 3A	160bottles (500ml)	PP tray*10	filter*1 set fan*1 LED light*1 7 inch LCD display alarming system	spare PP tray galvanized steel shelf spare filter
CFS-G1600	1600*510*2150	1560*432*1720	220m³/h	220V/50Hz 110W 3A	320bottles (500ml)	PP tray*10		
CFS-GS819	819*354*725	753*322*519	75m³/h	220V/50Hz 42W, 3A	48bottles (500ml)	PP tray*2		

DUCTLESS FLAMMABLE REFRIGERATOR WITH SMART FILTRATION SYSTEM

Flammable material refrigerators or freezers are designed to prevent ignition of flammable vapors inside the storage compartment. The flammable liquid is defined by the fire code of the flash point less than 100°F (38°C). In the biochemical research, low temperature storage is the solution to maintain biological activity. With filtration system installed, CATEC flammable refrigerator will not only keep the stored chemicals safe, but also protect the researchers safe from the pollution.

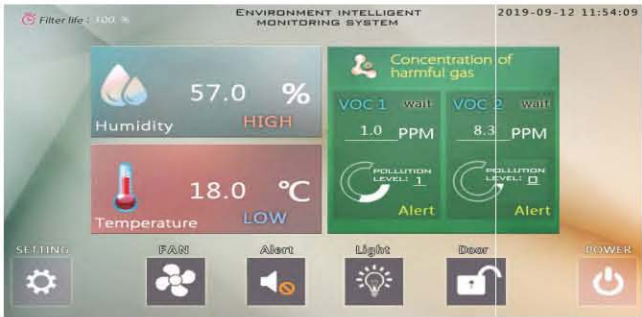

Technical details	
Part No.	CFS-JL518F
Dimension	Outer size: W690*D661*H2072mm, Inner size: W545*D550*H1430mm(subject to ±3% difference for different lots)
Filtration system	Special designed outside loop filtration system, to keep your laboratory away from pollution that caused by stored reagents. As per standard of ASTM, for particles of 0.3um, the filtration rate is up to 99.995%.
Refrigeration system	Default refrigeration target is 5°C. The resettable temperature range is 0°C-RT (room temp.). Users can reset the refrigeration target as per their demand. Twin-motor system to avoid the mutual interference of refrigeration and filtration and to enable the smooth air circulation.
Max filtration capacity	240m³/h
Inner cubage	0.4m³
Storage capacity	64 bottles (500ml/bottle)
Max power	76watt
Max current	3A
Noise	40dba
Net weight	70kg (subject to ±5% difference for different lots)
Power output/input	Output 24V DC, input 100~240V.
Cabinet material	Aluminum alloy profile cabinet, acrylic window
Shelf loading	25kg
Locking system	Electric locking system with code reading via the touch screen
Material holding plank	4 pcs SS planks with option of PP trays
LCD Control screen	1.Smart control system via LCD 7" touch screen, with resolution 800*480, and with operation instruction attached for user's easy working. 2.Real-time monitoring for temperature/humidity and VOC (volatile organic compounds), any of which reaches the set limitation, the buzzer will ring for alarming. 3.Auto switching blower when VOC1 or VOC2 reaches the set limitation, which can be shut off manually. And the volume of fanning will be based on the pollution degree. 4.Filter working life monitoring, with defaulted working life as 20000hrs (resettable) to be cut down when working. 5.Display error:±2%RH / ± 0.2 °C.

FUME HOOD

Features

1. Fume Hood, also called fume cupboard or fume cabinet: main structure is made of high quality PP board, perfect for resisting corrosion and heat. It is applicable to various kinds of laboratories with high requirement for cleanliness, for example: pharmaceutical laboratory, food laboratory, semiconductor laboratory, trace metal laboratory, biology laboratory, etc. It is widely used in the industries such as chemical, medical, car, steel plant, university and pharmaceutical scientific research institute.
2. Panoramic view sash: vertical movable 5mm tempered glass, low turbulence, easy positioning.
3. Worktop: PP board, optional for epoxy resin, or ceramics for specific needs.
4. Lighting: 30W/40W fluorescent lamp and switch.
5. Power: AC220V,50-60HZ, or as demanded.
6. Exhaust system: subuliform gas collecting hood.



Technical details

Model spec.	CF1200	CF1500	CF1800
Outer dimension(L*W*H)	1200*850*2350mm	1500*850*2350mm	1800*850*2350mm
Max door open	820mm (vertically adjustable)		
exhaust flux at air speed 0.5m/s	23.4CMM/840CFM	30.6CMM/1100CFM	50.8CMM/1825CFM
Working board material	White PP,thickness 8MM, bending designed to avoid spilling over. options for solid physiochemical board or epoxy resin or ceramic.		
operation window	Transparent tempered glass, thickness 5MM		
Gas collecting hood	Conical necking type		
Standard parts			
Lighting device	All cover fluorescent 30Wx1	All cover fluorescent 30Wx1	All cover fluorescent 40Wx1
Power socket	AC220V/10A X 4pcs		
Power switch board	For light, operation panel and general on/off control		
Remote control water valves	For pure water and pipe water		
PP sink	1pcs		
Options for other parts			
Cups,sinks,air cocks, water cocks, air blowers, power sockets,explosion-proof lighting,Venturi valve control, Butterfly valve control, converter control,touch pad, Surface wind speed detection, sound and light alarm, etc.			

POLYPROPYLENE CHEMICAL CABINET



Functions



White PP board, with strong acid and alkali resistance and anti-corrosive characteristics.



Special designed cabinet top, available for working table



Two padlocks design, for higher level security.



The layer is removable and adjustable for improving the space usage.



Reduce environment pollution, and protect safety of operator.

Technical details

Spec	Capacity (litre)	Outer Size (W*D*H/mm)	Inner Size (W*D*H/mm)	Weight(kg)	Parts
CFS-P004	15	430*430*560	350*330*460	34	one door/manual, 1 PP shelf, two padlocks
CFS-P012	45	590*460*890	510*360*790	60	
CFS-P022	83	600*460*1650	520*360*1550	90	two doors/manual, 1 PP shelf, two padlocks
CFS-P030	114	1090*460*1120	1010*360*1020	100	
CFS-P045	170	1090*460*1650	1010*360*1550	138	
CFS-P060	207	860*860*1650	780*760*1550	165	two doors/manual, 2 PP shelves, two padlocks
CFS-P090	340	1090*860*1650	1010*760*1550	190	
CFS-MP900	170	900*450*1800	820*350*1700	160	two /four doors/manual, 2 PP shelves
CFS-CP900	170	900*450*1800	820*350*1700	160	two /four doors/manual, 2 perforated shelves

FLAMMABLE SAFETY CABINET



OPTIONAL SPECIAL DESIGNS

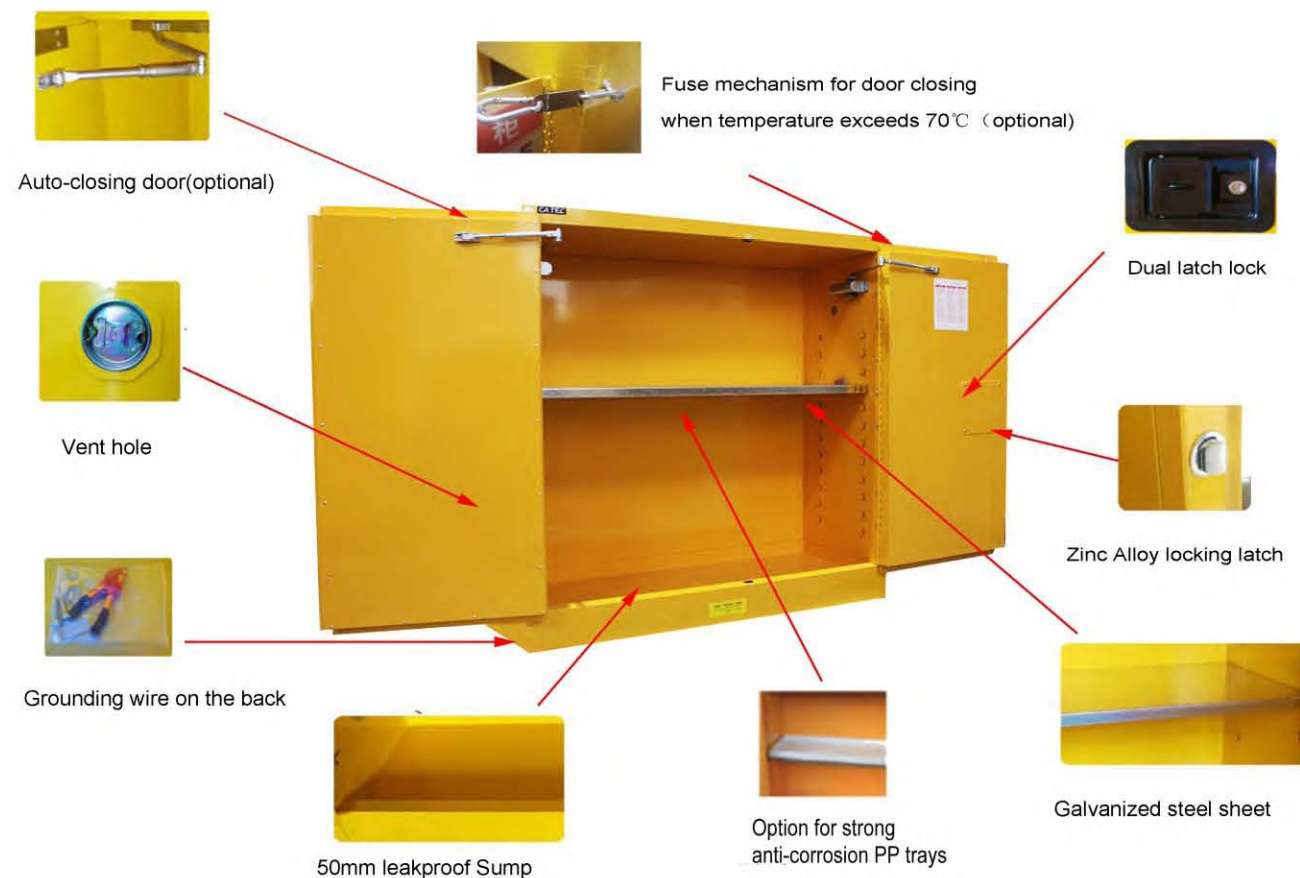

- Yellow indicates flammable liquids
- Red indicates combustible liquids
- Blue indicates weak acids and weak bases

Technical details of flammable safety cabinet

Model name	Material	Length (mm)	Width (mm)	Thickness (mm)	Applicable spec	Remarks
Shelf	Galvanized steel sheet	348	330	25	CFS-G004	For STD spec
Shelf	Galvanized steel sheet	508	360	25	CFS-G012	
Shelf	Galvanized steel sheet	1008	360	25	CFS-G030 CFS-G045	
Shelf	Galvanized steel sheet	778	760	25	CFS-G060	
Shelf	Galvanized steel sheet	1008	760	25	CFS-G090	
Pallet	Galvanized steel sheet/PP board	340	330	10/58	CFS-G004	For options
Pallet	Galvanized steel sheet/PP board	500	360	10/58	CFS-G012	
Pallet	Galvanized steel sheet/PP board	1000	360	10/58	CFS-G030 CFS-G045	
Pallet	Galvanized steel sheet/PP board	770	760	10/58	CFS-G060	
Pallet	Galvanized steel sheet/PP board	1000	760	10/58	CFS-G090	

Model name	Capacity (liters)	Outer dmlention (W*D*H/mm)	Inner dmlention (W*D*H/mm)	Weight (kg)	Parts
CFS-G004	15	430*430*560	350*330*460	34	One door/manual, 1 shelf, one earthing cable
CFS-G012	45	590*460*890	510*360*790	60	One door/manual, 1 shelf, one earthing cable
CFS-G022	83	600*460*1650	520*360*1550	90	One door/manual, 3 shelves, one earthing cable
CFS-G030	114	1090*460*1120	1010*360*1020	100	2 doors/manual, 1 shelf, one earthing cable
CFS-G045	170	1090*460*1650	1010*360*1550	138	2 doors/manual, 2 shelves, one earthing cable
CFS-G060	207	860*860*1650	780*760*1560	165	2 doors/manual, 2 shelves, one earthing cable
CFS-G090	340	1090*860*1650	1010*760*1550	190	2 doors/manual, 2 shelves, one earthing cable

DRUM SAFETY STORAGE CABINET

Drum safety cabinet is specially used for the storage of one or two international standard vertical drums.
Unique double-wall design and explosion-proof function make sure the safety of environment.
Optional single or double drum rollers at the bottom for easy moving.



Technical details

Spec	Capacity (gallon)	Outer Size (W*D*H/mm)	Inner Size (W*D*H/mm)	Weight (kg)	Door Type	Parts
CFS-55OS	60	860*860*1650	780*760*1550	195	manual	two doors one shelf one earthing cable one drum roller
CFS-55OSA					auto closing	
CFS-110OD	110	1500*860*1650	1420*760*1550	355	manual	two doors one shelf one earthing cable two drum rollers
CFS-110ODA					auto closing	

SMART FLAMMABLE & HAZARDS SAFETY CABINET

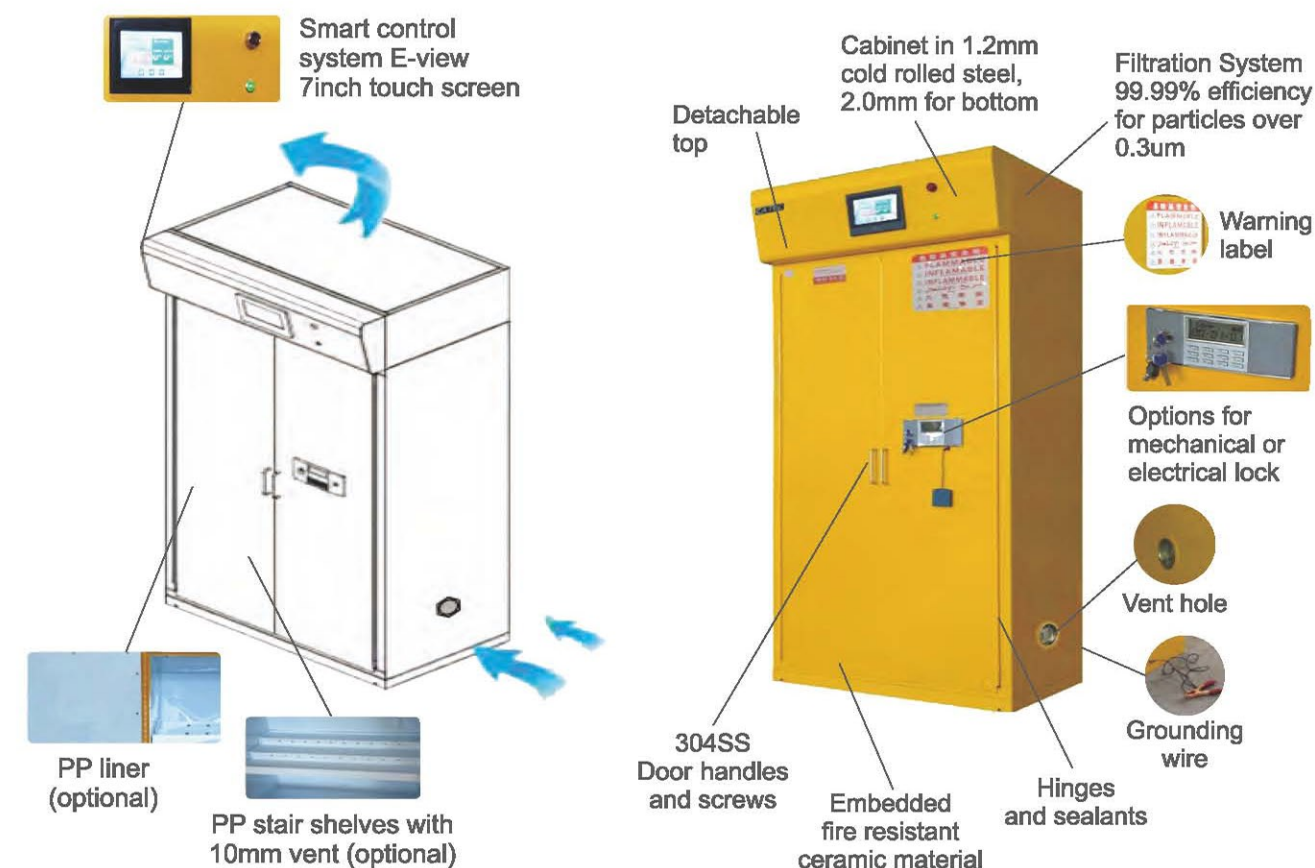

Technical details

Spec	Outer Size (W*D*H/mm)	Power	Capacity	Color	Shelf qty	Other Details	Parts Option
CFS-ZY030	1090*460*1400	220V/50Hz 40W 2A	30 gallon	yellow	galvanized steel board*1	electric secure lock Filter*1set fan*1 7 inch LCD display power line alarming system	PP liner PP stepped shelves spare shelf spare filter
CFS-ZB030				blue			
CFS-ZY045	1090*460*1930		45 gallon	yellow	galvanized steel board*2		
CFS-ZB045				blue			

GAS CYLINDER STORAGE CABINET

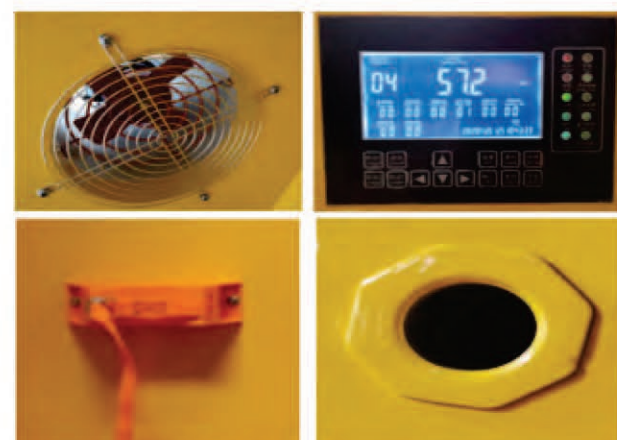

Features

1. Welded 1.2mm thickness steel, designed to meet international standards of OSHA and NFPA (CODE30).Double-walled steel structure for fire proof.
2. Explosion-proof cabinet with explosion-proof glass windows and all the other accessories are explosion-proof.
3. Industrial special locking system for security.
4. Vent hole on the side of the cabinet to ensure the gas flow in the cabinet.
5. Quality fixed belts to keep the gas cylinder stand firmly.
6. Special options:
 - Combustible gas detection alarm: when the gas alarm detects that the gas concentration reaches the critical point of the lower or upper explosion limit, it will send out an alarm signal.
 - Special gas detection alarm: select special gas detection alarm device according to the storage condition of gas cylinder, with high sensitivity and accuracy, more safe and reliable.
 - Automatic exhaust system: When the sensor in the cabinet detects the gas leakage and gives an alarm, the top fan will automatically work to discharge the gas out of the room through the exhaust pipe.
 - Alarming system for temperature or humidity limitations.
 - Smoke alarm: alarm when the inside smoke concentration exceeds the setting value.
 - Auto-closing door(optional).
 - Adjustable fold down ramp, for easy loading or unloading the gas cylinder.

Technical details

Spec	Outer Size (W*D*H/mm)	Weight(kg)	Gas Cylinder	Door Type	Options
CFS-GC101	600*450*1900	63	single	single	alarm blower auto-closing door
CFS-GC102	900*450*1900	90	double	double	

MOVABLE FUME EXTRACTOR



Features

1. Epoxy ESD coated 1.2mm galvanized steel structure, endureable lead free paint, strong anti-erosion.
2. 7 inch LCD touch screen panel, smart control for real time VOC, temperature and humidity movement, with resettable alarming system.
3. High efficiency filtration system as per ASTM standard for acid and alkali gas(filtration rate 99% for VOC), also 99.995% filtration rate for particles over 0.3um.
4. Imported PSC fan made in USA, stable functioning, ultra-low noise, and no static sparkle.

Technical details

Spec	Outer Size (W*D*H/mm)	Fan Installed (pcs)	Filters (Layer)	Filtration Capacity(m³/h)	Power (W)	Noise	Gross Weight (kg)
CFS-MX600	600*460*460	1	4	240	160	≤60db	37.5

CUSTOMIZED VACUUM DRYING OVEN

Model name	Spec	Inner Size (W*D*H/mm)	Outer Size (W*D*H/mm)	Technical parameters	Shelf qty (pcs)
High-temp blast drying oven	HCTG-9030A	320*320*300	560*520*700	100-250℃,220V,50Hz, error 0.1℃/±0.5℃, 2000-5500W timing 0-9999min	2
	HCTG-9050A	410*350*350	640*600*695		2
	HCTG-9100A	450*450*450	890*750*650		2
	HCTG-9200A	600*600*600	945*850*840		2

Vacuum Pump Technical Data

Model		DM2	DM4	DM8	DM15
Displacement speed(L/S)		2	4	8	15
Ultimate partial pressure(Pa)	without gas ballast	≤4X10 ⁻²	≤4X10 ⁻²	≤4X10 ⁻²	≤4X10 ⁻²
	with gas ballast	≤8X10 ⁻²	≤8X10 ⁻²	≤8X10 ⁻²	≤8X10 ⁻²
Ultimate total pressure(Pa)	without gas ballast	≤5X10 ⁻¹	≤5X10 ⁻¹	≤5X10 ⁻¹	≤5X10 ⁻¹
	with gas ballast	≤8X10 ⁻¹	≤8X10 ⁻¹	≤8X10 ⁻¹	≤8X10 ⁻¹
Noise Lp/Lw dB(A)		52/63	54/65	58/71	59/72
Inlet port(DN)		25KF	25KF	40KF	40KF
Outlet port(DN)		25KF	25KF	40KF	40KF
Oil filling(L)		1.1	1.5	3	4
Rotational speed of pump(r/min)		1400	1430	1400	1420
Motor power(kw)		0.37	0.55	1.1	1.5(2.2)
Weight(kg)		24	31	60	70
Overall dimensions(mm)		510*174*274	550*174*274	650*236*383	700*236*383



Safety Guarantee System:

Temperature exceeding alarm

Under phase and phase loss protection

Over current protection

Prompt fusing system

Grounding protection



Features

- Vacuum oven is designed specially for drying of material which is thermo-sensitive or decomposed and oxidative easily. Your materials will be processed correctly in the closed vacuumed space to bear the high temperature baking for resettable time as demanded.
- The oven shell is made of high-quality cold-rolled steel plate, sprayed with electro static powder.
- The working space is made of 304 stainless steel, with rounded corners, smooth and easy to clean.
- Between the shell and the working room, filled with ultra-fine glass wool insulation materials, double-layer glass structure, for easy observing and heat insulation, keeping the operators safe from high temperature burning.
- Strengthened glass door with heat-resistant rubber sealing ring to ensure a high vacuum in the box.
- Temperature control by microcomputer intelligent digital technology, to ensure high temperature control accuracy, strong anti-interference and convenient operation.

Technical details

Characteristics	VCTF-6600N	VCTF-6500N
Dimension: W*D*H(mm)	Outer:850*1080*2050 Inner:680*900*990	Outer:790*1310*1850 Inner: 630*810*845
Plank qty (pcs)	3	
Temperature range	RT+10~250℃	
Temperature resolution	0.1 °C	
Temperature fluctuation	± 0.1 °C	
Consume power	9500W	
Vacuum degree	<133Pa	
Power input	AC 380V±10% / 50Hz±2%	

NITROGEN CABINET

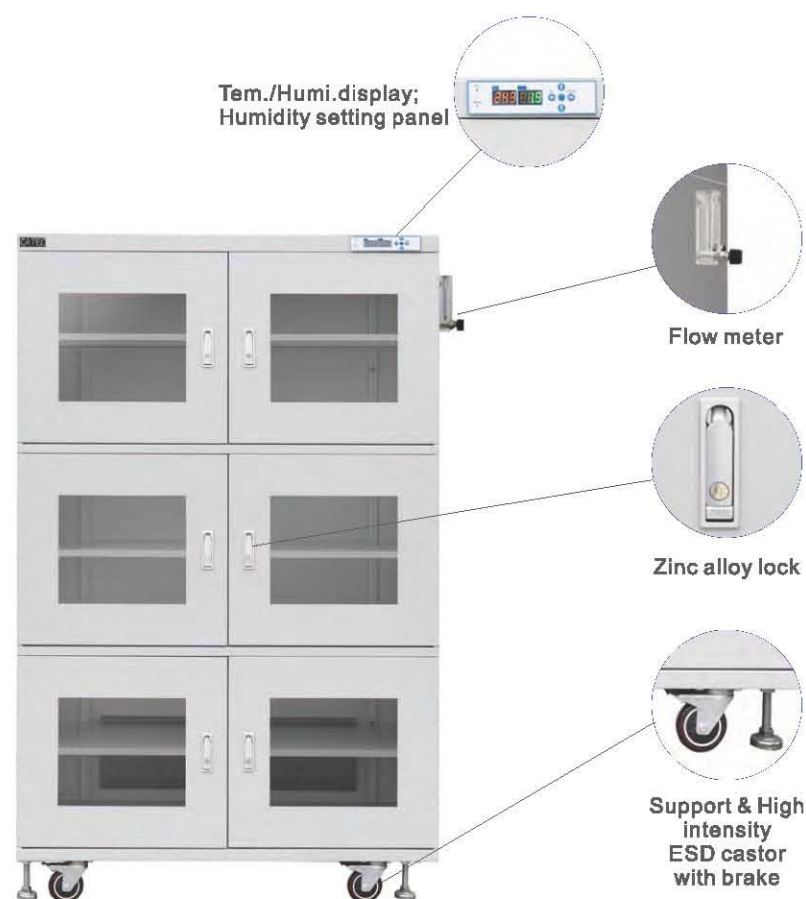

Features

- LED display, imported humidity sensor with error as $\pm 3\%$ RH.
- Quality 1mm and 1.2mm cold rolled steel, reinforced structure design, high intensity bearing.
- 3.2mm tempered glass.
- Zinc alloy lock with air press.
- High intensity truckle with brake.
- RoHs certified advanced powder coating technology with Dupont powder, high anti-erosion performance to avoid your stored goods from pollution, static shock, and oxidation.
- AC power 85V-265V 50/60Hz.
- Available for nitrogen gas or compressed air for 1-60% RH.
- Options for air flow ranges 5-25LPM, 5-60LPM, 5-300LPM.

Non-ESD	Anti-ESD	Controlled Humidity (RH)	Average Power(W)	Outer Size (W*D*H/mm)	Inner Size (W*D*H/mm)
DRY98D	DRY98ED	1-60%RH	8	448*400*688	446*372*598
DRY160D	DRY160ED	1-60%RH	8	448*450*1010	446*422*848
DRY240D	DRY240ED	1-60%RH	8	598*400*1310	596*372*1148
DRY320D	DRY320ED	1-60%RH	8	900*450*1010	898*422*848
DRY435D	DRY435ED	1-60%RH	8	900*600*1010	898*572*848
DRY540D	DRY540ED	1-60%RH	8	598*710*1465	596*682*1298
DRY718D	DRY718ED	1-60%RH	8	598*710*1910	596*682*1723
DRY870D	DRY870ED	1-60%RH	8	900*600*1890	898*572*1698
DRY1436D-4	DRY1436ED-4	1-60%RH	8	1200*710*1910	1198*682*1723
DRY1436D-6	DRY1436ED-6	1-60%RH	8		

MINI N2 GENERATOR

Technical spec

Model: CT-NG1815C
Outer size (W*D*H): W350*D500*H751mm
N2 produce capacity: 13L /min
Purity of N2: over 99%
N2 concentration: 98% - 99.9%
Working condition: 0 ~ 50°C ambient temperature
Display: highlight LED
Power input: 220V 50Hz/60Hz self-adaption
Stand-by power consumption: ≤ 10 W
Max power consumption: ≤ 40 W
Surface color: dark green, anti-ESD



attachable for N2 cabinet

DIGITAL AMBIENT TEMPERATURE AND HUMIDITY MONITOR

Features

- Humidity and temperature display and monitor range
 - Temperature range: -9.9 to +70°C, error: $\pm 1.0^\circ\text{C}$
 - Humidity range: 0.1 to 99.9% RH, error $\pm 3.0\%$ RH
 - Outer dimensions: W340*H360*D55mm
 - Working voltage: 85- 240V AC
 - Power: ≤ 5 W
- Alarming system with high decibel buzzer (>70dB) and indicators, when humidity or temperature exceeds the alarming value, the buzzer will flash and alarm

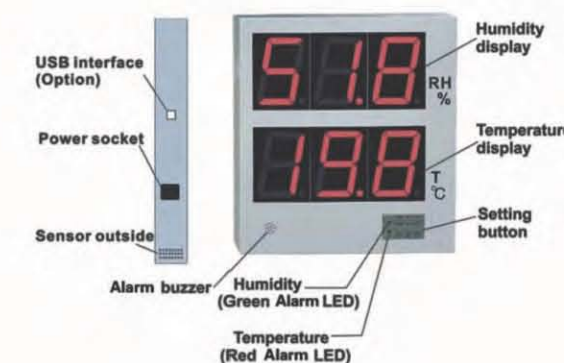

Technical details

Spec	Temperature Range (°C)	Humidity Range (RH)	Display Number	USB Connection (Y/N)
CTT-18D	-9.9 to +70°C($\pm 1.0^\circ\text{C}$)	0.1 to 99.9%($\pm 3.0\%$ RH)	single	N
CTT-18DU	-9.9 to +70°C($\pm 1.0^\circ\text{C}$)	0.1 to 99.9%($\pm 3.0\%$ RH)	single	Y
CTT-18DT	-9.9 to +70°C($\pm 1.0^\circ\text{C}$)	0.1 to 99.9%($\pm 3.0\%$ RH)	double	N
CTT-18DUT	-9.9 to +70°C($\pm 1.0^\circ\text{C}$)	0.1 to 99.9%($\pm 3.0\%$ RH)	double	Y

DRY CABINET WITH COMPOUNDED FUNCTIONS TO RESIST OXIDATION AND HUMIDITY DAMAGE

Drying cabinet in stainless steel



Drying cabinet with heating up to 40°C or 60°C

To meet the demands for some special items that require low temperature baking available for models of DRY320/DRY435/DRY870/DRY1436.



Drying cabinet with oxygen content detection:

The main purpose of humidity control storage is to keep the MSD from oxidation. However, the low humidity does not necessarily mean a low oxygen content. So we add the oxygen content detection system is necessary for those components made of brass, bronze, silver, tungsten, gold, etc. that are most likely to go oxidized.

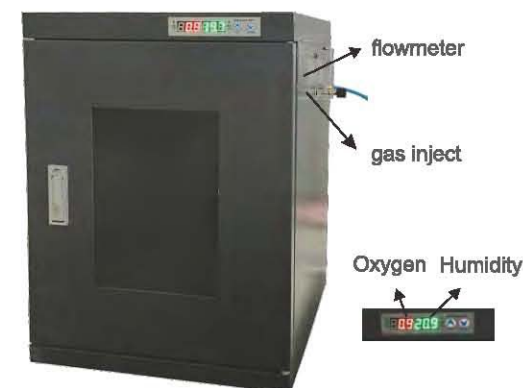

Drying cabinet with independent segregated compartments:

Each compartment is an independent working space, when you open one of the compartments, the others won't be affected. Available for models of DRY320/DRY435/DRY718/DRY870/DRY1436.



Drying cabinet with nitrogen generator attached:

Besides humidity controlled by the patented drying module, there's a N2 generator attached to produce endless nitrogen to purge into the cabinet to meet your demand of anti-oxidation. Available for models of DRY870/ DRY 1436.



Drying cabinet with buzzer or light tower alarming



Drying cabinet with drawers

